



HERS OF H. BRUSH SURVEY NO. 1137  
ABSTRACT NO. 117

W. RICE SURVEY NO. 6  
ABSTRACT NO. 1379

I. RICE SURVEY NO. 6  
ABSTRACT NO. 1712

ANNA C. GARDNER/ROF  
SURVEY NO. 1030  
ABSTRACT NO. 1335

T. & N.O. RR. CO.  
SURVEY NO. 3  
ABSTRACT NO. 1374

JOHANN LUDWIG SURVEY NO. 318  
ABSTRACT NO. 949

JOHANN LUDWIG SURVEY NO. 317  
ABSTRACT NO. 952

(1934.8 ACRES)  
457/237 M.C.D.R.

(431.9 ACRES)  
422/041 M.C.D.R.

(2431.1 ACRES)  
472/539 M.C.D.R.

(333.81 ACRES)  
472/534 M.C.D.R.

(139.2 ACRES)  
160/132 M.C.D.R.

(243.3 ACRES)  
160/772 M.C.D.R.

(137.95 ACRES)  
160/289 M.C.D.R.

(8.5 ACRES)  
160/24 M.C.D.R.

(1140.483 ACRES)  
26/726 M.C.D.R.

(129 ACRES)  
160/720 M.C.D.R.

(1340 ACRES)  
160/710 M.C.D.R.

(1379.5 ACRES)  
160/289 M.C.D.R.

(1317.9 ACRES)  
160/289 M.C.D.R.

(49.05 ACRES)  
162/284 M.C.D.R.

(231.4 ACRES)  
160/8 M.C.D.R.

(139.2 ACRES)  
160/132 M.C.D.R.

(243.3 ACRES)  
160/772 M.C.D.R.

(1379.5 ACRES)  
160/289 M.C.D.R.

(1317.9 ACRES)  
160/289 M.C.D.R.

(49.05 ACRES)  
162/284 M.C.D.R.

(231.4 ACRES)  
160/8 M.C.D.R.

(139.2 ACRES)  
160/132 M.C.D.R.

(243.3 ACRES)  
160/772 M.C.D.R.

(1379.5 ACRES)  
160/289 M.C.D.R.

(1317.9 ACRES)  
160/289 M.C.D.R.

(49.05 ACRES)  
162/284 M.C.D.R.

(231.4 ACRES)  
160/8 M.C.D.R.

(139.2 ACRES)  
160/132 M.C.D.R.

(243.3 ACRES)  
160/772 M.C.D.R.

(1379.5 ACRES)  
160/289 M.C.D.R.

(1317.9 ACRES)  
160/289 M.C.D.R.

(49.05 ACRES)  
162/284 M.C.D.R.

(231.4 ACRES)  
160/8 M.C.D.R.

(139.2 ACRES)  
160/132 M.C.D.R.

(243.3 ACRES)  
160/772 M.C.D.R.

(1379.5 ACRES)  
160/289 M.C.D.R.

(1317.9 ACRES)  
160/289 M.C.D.R.

(49.05 ACRES)  
162/284 M.C.D.R.

(231.4 ACRES)  
160/8 M.C.D.R.

(139.2 ACRES)  
160/132 M.C.D.R.

(243.3 ACRES)  
160/772 M.C.D.R.

(1379.5 ACRES)  
160/289 M.C.D.R.

(1317.9 ACRES)  
160/289 M.C.D.R.

(49.05 ACRES)  
162/284 M.C.D.R.

(231.4 ACRES)  
160/8 M.C.D.R.

(139.2 ACRES)  
160/132 M.C.D.R.

(243.3 ACRES)  
160/772 M.C.D.R.

(1379.5 ACRES)  
160/289 M.C.D.R.

(1317.9 ACRES)  
160/289 M.C.D.R.

(49.05 ACRES)  
162/284 M.C.D.R.

(231.4 ACRES)  
160/8 M.C.D.R.

(139.2 ACRES)  
160/132 M.C.D.R.

(243.3 ACRES)  
160/772 M.C.D.R.

(1379.5 ACRES)  
160/289 M.C.D.R.

(1317.9 ACRES)  
160/289 M.C.D.R.

(49.05 ACRES)  
162/284 M.C.D.R.

(231.4 ACRES)  
160/8 M.C.D.R.

(139.2 ACRES)  
160/132 M.C.D.R.

(243.3 ACRES)  
160/772 M.C.D.R.

(1379.5 ACRES)  
160/289 M.C.D.R.

(1317.9 ACRES)  
160/289 M.C.D.R.

(49.05 ACRES)  
162/284 M.C.D.R.

(231.4 ACRES)  
160/8 M.C.D.R.

(139.2 ACRES)  
160/132 M.C.D.R.

(243.3 ACRES)  
160/772 M.C.D.R.

(1379.5 ACRES)  
160/289 M.C.D.R.

(1317.9 ACRES)  
160/289 M.C.D.R.

(49.05 ACRES)  
162/284 M.C.D.R.

(231.4 ACRES)  
160/8 M.C.D.R.

CONCRETE  
BUILDING

CONCRETE  
BUILDING

CONCRETE  
BUILDING

CONCRETE  
BUILDING

CONCRETE  
BUILDING

CONCRETE  
BUILDING

CONCRETE  
BUILDING

CONCRETE  
BUILDING

CONCRETE  
BUILDING

CONCRETE  
BUILDING

CONCRETE  
BUILDING

CONCRETE  
BUILDING

CONCRETE  
BUILDING

CONCRETE  
BUILDING

CONCRETE  
BUILDING

CONCRETE  
BUILDING

CONCRETE  
BUILDING

CONCRETE  
BUILDING

DETAIL  
SCALE: 1"=50'

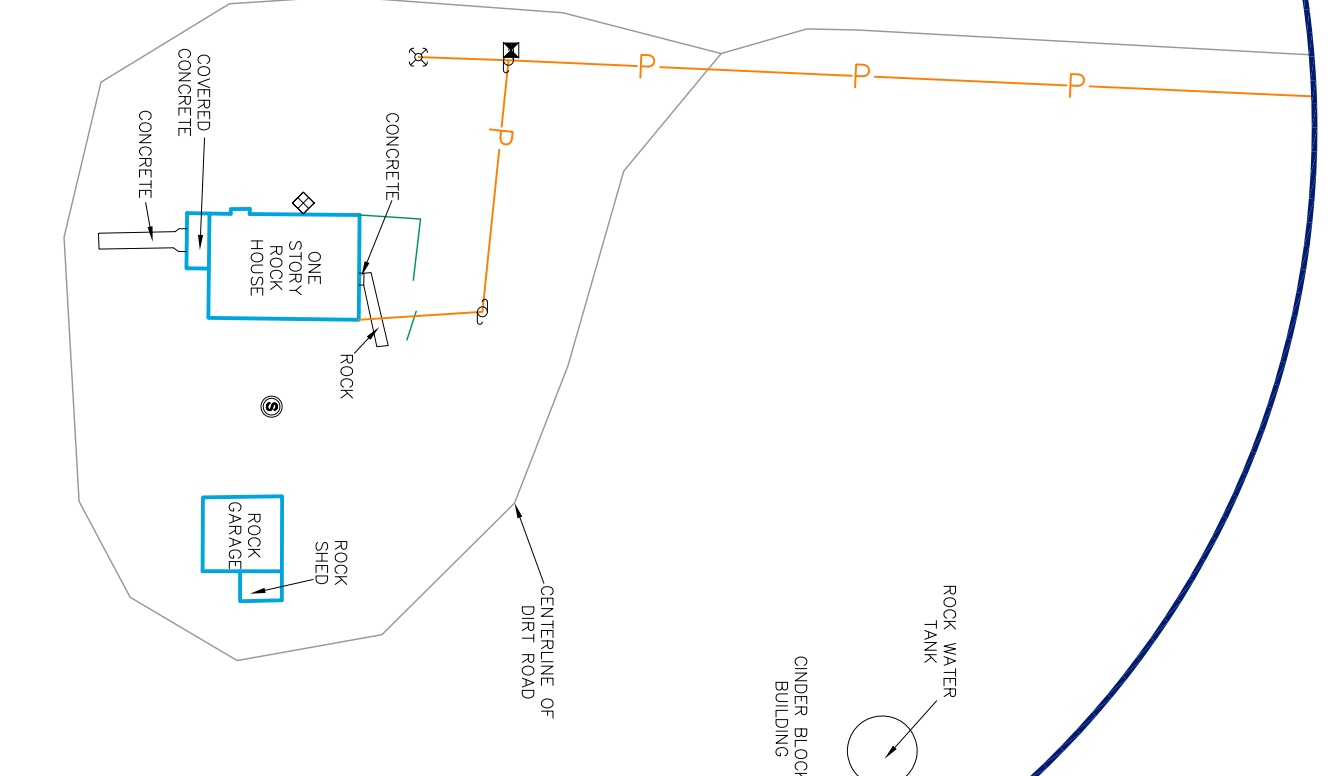

LEGEND: Symbols for various survey features like boundaries, easements, and structures.

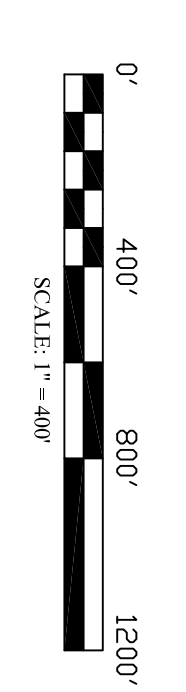

SURVEY NOTES: 1. BEARINGS, DISTANCES & ANGLE... 2. THIS SURVEY WAS PROVIDED... 3. A 1/2 INCH IRON ROD... 4. A 1/2 INCH IRON ROD...

EXHIBIT PLAT: OF PARTS OF BRADY AND BRADY LAKE IN THE CITY OF BRADY, WASHINGTON COUNTY, TEXAS... JOHANN LUDWIG SURVEY NO. 317 ABSTRACT NO. 952